

MAGNETIC NORTH
1983

OWNER
STEPHEN W. BROWN
CLINTON, MAINE

SURVEYOR
MICHAEL W. DEMO
CALUMAS, MAINE
LICENSE NO. 417

SOILS
SOIL TEST BY A. E.
HODGSON III,
LICENSE NO. 046.

LEGEND
Iron pin ○
Wood stake +
Wire fence ———
Split & wire fence ———
Soil nest □
Maple tree D

NOTE
The town of Thorndike
will not be required provide
road maintenance to
Lot 14.

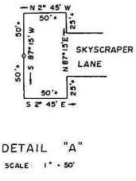

This is to certify that after reviewing the subdivision shown by this plan and considering each of the criteria set forth in 30 M.R.S.A. subsection 4956 as amended the undersigned have made findings of fact establishing that the proposed subdivision meets all of the criteria set forth and therefore the subdivision is APPROVED.

PLANNING BOARD TOWN OF THORNDIKE:

Therese Jenkins *David S. Tucker*
Carrie Johnson *Ronnie H. Blaine*

AMENDED PLAN OF
COUNTRY VIEW ESTATES

TOWN:
THORNDIKE

\$69,000

- 0 baths
- Land
- Active

LOT 12 MOULTON HILL LANE, THORNDIKE, ME, 04986

<https://agent207.com>

Wooded lot with potential views, ready for your forever home or camp. Come for the peace and quiet of interior Waldo County. The property is located just 30 minutes from the coastal town of Belfast. and 35 minutes from Waterville. Looking for rural living with privacy? This property might be exactly what you're looking for.

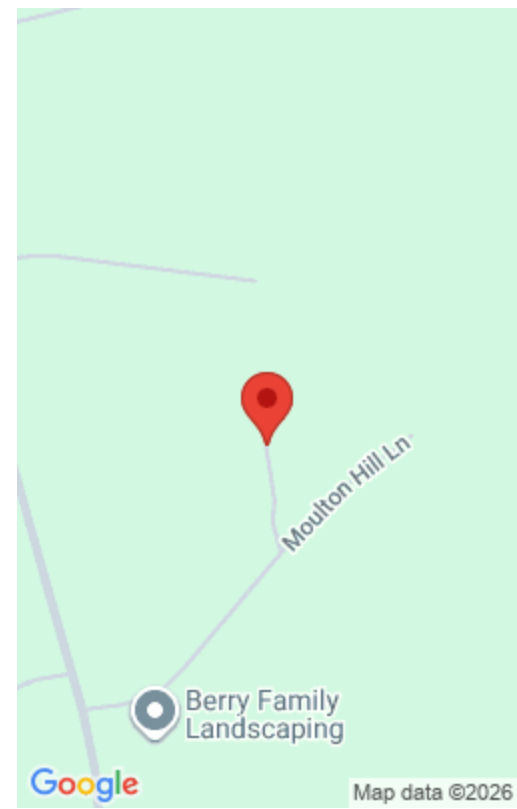

Basics

Category: Land

Bathrooms: 0 baths

Subdivision Name: Informal

Zoning: Rural

Status: Active

Lot size: 10.3 sq ft

Lot Size Acres: 10.3 acres

County: Waldo

Building Details

Sewer: None

Amenities & Features

Electric: No Electric

Parking Features: No Driveway, 1 - 4 Spaces

WaterSource: None

Lot Features: Rolling/Sloping, Right of Way, Wooded, Rural

Miscellaneous

Road Surface Type: Gravel

Pets Allowed: No Restrictions

Courtesy of

List Office Name: Coldwell Banker Plourde Real Estate

